



Town of Moosonee Dog Holding Facility RFP

Request for Proposal (RFP)

Project Title: Site Clearing, Preparation, and Placement of Dog Holding Facility

Location: Mistik Blvd, Town of Moosonee

RFP Number: RFP-201

Date of Issue: October 28, 2024

Closing Date: November 5, 2024

1. Project Overview

The Town of Moosonee is seeking qualified contractors for site preparation, placement of a dog holding facility, and water and sanitary service connections. The site requires minimal clearing and grading. The project involves road construction, gravel pad installation, water and sanitary service connections, and the placement of a pre-fabricated Sea Can structure. Ideally the project would be completed in November/December 2024, with flexibility to discuss the timeline.

Attachments:

- Site Grading Plan
- Google Earth Location Map
- Sea Can Specifications and Sketch

2. Scope of Work

The contractor will be responsible for the following tasks:

- **Site Clearing & Grading:**
Clearing and grading as per the provided site grading plan. The areas outside of the gravel pad will be sloped as shown on the layout drawing.
- **Driveway Construction:**
 - **Main Driveway:** Construct an 80-meter-long by 4-meter-wide driveway using geotextile cloth and aggregate.
 - **Aggregate Thickness:** 8 inches (0.2032 meters).
 - **Ditches:** Construct ditches on either side of the roadway for drainage.
 - **Volume of aggregate required for the main driveway:** approximately 65 cubic meters.

- **Gravel Pad for Sea Can:**
Create a gravel pad for the dog holding facility (Sea Can).
 - **Dimensions:** 30 meters long by 15 meters wide.
 - **Aggregate Thickness:** 8 inches (0.2032 meters).
 - **Volume of aggregate required for the gravel pad:** approximately 92 cubic meters.
- **Placement of Dog Holding Facility (Sea Can):**
Once the gravel pad is prepared, place the Sea Can securely on the pad according to the provided specifications.
- **Water and Sanitary Services Installation:**
 - **Water Line:** Install approximately 85 meters of ¾-inch water line from the municipal main to the dog holding facility. The water connection must be brought to the designated area as shown in the Sea Can sketch.
 - **Sanitary Line:** Install approximately 85 meters of 5-inch sanitary pipe from the municipal main to the facility. Minimum of 4-6 inches of pipe bedding required for sanitary service.
 - **Connection Location:** Both the water and sanitary lines must be installed on the side of the building, with the water line protected by insulated and heat-traced cables to prevent freezing.
 - **Tie-In:** Ensure proper connection of water and sanitary services to the municipal lines. The Town will provide service saddles and water and sewer materials; the contractor must provide labor and equipment for installation.
- **Final Site Grading:**
Complete final grading of the surrounding site per the grading plan to ensure proper drainage and site functionality.

3. Volume of Aggregate Required

- **Main driveway (61 meters x 4 meters x 0.2032 meters (8 inches)):** 65 cubic meters
- **Gravel pad for Sea Can (30 meters x 15 meters x 0.2032 meters (8 inches)):** 92 cubic meters

4. Insurance Requirements

The selected contractor must provide proof of insurance before the project begins. Typical Ontario municipal insurance requirements include:

- **Commercial General Liability Insurance:** Minimum coverage of \$5,000,000 per occurrence, naming the Town of Moosonee as an additional insured.
- **Automobile Liability Insurance:** Minimum coverage of \$2,000,000 for all vehicles used in connection with the project.

- **WSIB Clearance Certificate:** Provide proof of good standing with the WSIB.

5. Deliverables

The contractor must:

- Complete site clearing, grading, and road construction.
- Construct the gravel pad and place the Sea Can.
- Install water and sanitary services with proper tie-ins.
- Ensure compliance with all local regulations and standards.
- Provide a final inspection and handover upon completion.

6. Proposal Submission Requirements

Proposals should include:

- A detailed cost breakdown for each component (site clearing, driveway, pad construction, placement, water, and sanitary services).
- Estimated project timeline.
- Proof of insurance and WSIB clearance.
- Equipment list and available resources.

7. Evaluation Criteria

Proposals will be evaluated based on:

- Competitive pricing and value.
- Experience in similar projects.
- Ability to meet timelines.
- Compliance with RFP requirements.

8. Submission Deadline

Proposals must be submitted no later than **November 8th, 2024, @ 3:00 PM** to: info@moosonee.ca

For questions or clarifications, contact: trevorkeefe@moosonee.ca

The Town of Moosonee reserves the right to accept or reject any proposal.

BID FORM

Project Title: Site Clearing, Preparation, and Placement of Dog Holding Facility

RFP Number: RFP-201

Closing Date: Friday November 8th, 2024, at 3:00 PM

Contractor Information

Company Name: _____

Contact Name: _____

Phone: _____

Email: _____

Address:

Cost Breakdown (Please itemize costs for each section below)

1. **Site Clearing & Grading**

Total Cost: \$ _____

2. **Driveway Construction**

• **Main Driveway** (approx. 80 meters x 4 meters x 0.2032 meters):

○ Volume of Aggregate: approx. 65 cubic meters

○ Total Cost: \$ _____

3. **Gravel Pad for Sea Can**

• **Gravel Pad** (approx. 45 meters x 10 meters x 0.2032):

○ Volume of Aggregate: approx. 92 cubic meters

○ Total Cost: \$ _____

4. **Delivery from Moosonee ONR Feight/Placement of Dog Holding Facility (Sea Can)**

Total Cost: \$ _____

5. **Water and Sanitary Service Installation – Material to be provided by Town**

• **Water Line** (Approximately 85 meters of ¾-inch line):

○ Total Cost: \$ _____

• **Sanitary Line** (Approximately 85 meters of 5-inch line, including pipe bedding):

○ Total Cost: \$ _____

6. **Final Site Grading**

Total Cost: \$ _____

Total Bid Amount (including all taxes):

\$ _____

Completion Timeline (Estimate):

Start Date: _____

End Date: _____

Equipment to be used for the project:

- _____
- _____

Relevant Experience in Similar Projects (Please attach supporting documents):

- Project 1: _____
- Project 2: _____
- Project 3: _____

Proof of Insurance:

Attached

To be provided upon selection

WSIB Clearance Certificate:

Attached

To be provided upon selection

Authorized Signature:

Name: _____

Title: _____

Date: _____

MOOSONEE DOG HOLDING FACILITY

ORIENTATION

PLAN ONLY (APPROXIMATE)

CAUTION: DO NOT SCALE DRAWINGS.
THIS REPRODUCTION MAY BE AT A SIZE DIFFERENT THAN ORIGINALLY DRAWN. EXP ASSUMES NO RESPONSIBILITY FOR INCORRECT SCALING, UNAUTHORIZED REPRODUCTION OR REUSE IS STRICTLY PROHIBITED, NOT PUBLISHED - ALL RIGHTS RESERVED. EXP EXPRESSLY DISCLAIMS RESPONSIBILITY ARISING FROM UNAUTHORIZED USE OF THESE DRAWINGS AND NOTES. AUTHORIZATION MUST BE IN WRITING.

© exp, 2024

DIMENSIONS NOTES:
1. ALL DIMENSIONS ARE IN METERS (m) UNLESS NOTED OTHERWISE.

LEGEND

- TREE LINE
- FENCE
- TOP OF DITCH
- BOTTOM OF DITCH
- GRAVEL OUTLINE
- EDGE OF SHOULDER

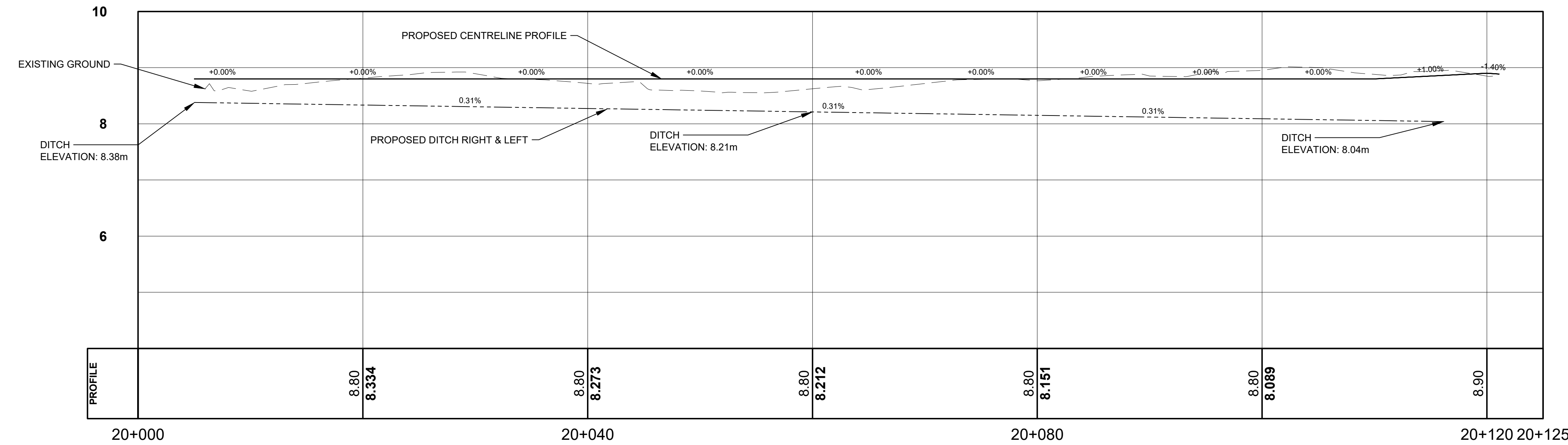
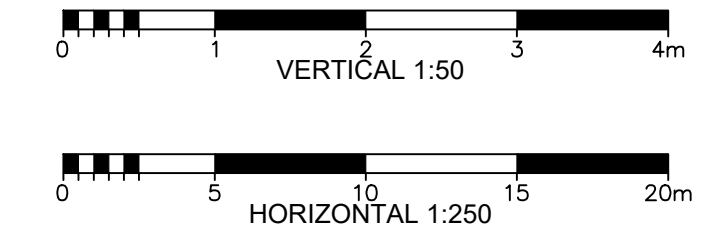
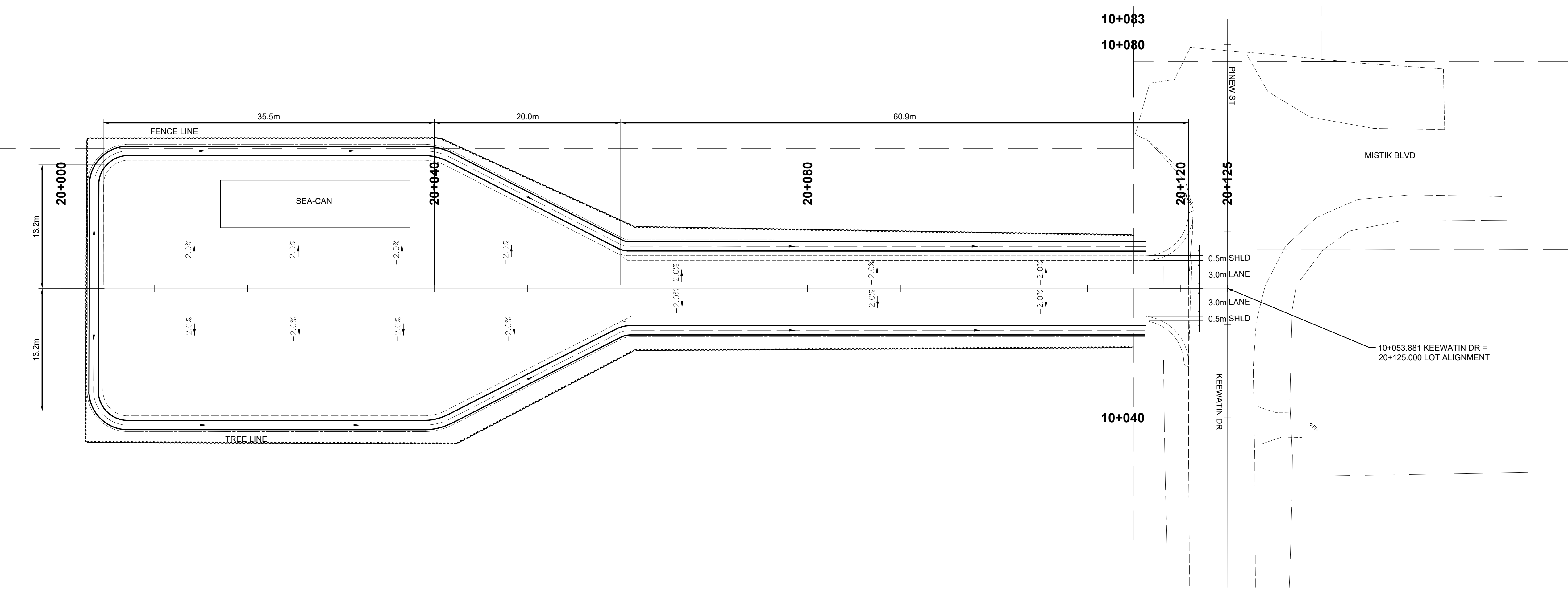

No.	DATE	REVISION	BY

CLIENT: TOWN OF MOOSONEE

PROJECT TITLE: MOOSONEE DOG HOLDING FACILITY

PROJECT No.: NWL - 24010098

DRAWING TITLE: NEW CONSTRUCTION / GRADING PLAN

DRAFT	DESIGNED	SCALE
	????	1:500
	DRAWN	PLAN No.
	AG	???
CHECKED	DRAWING No.	
???		

EXP Services Inc.
1-705-647-4311 | F: 1-705-647-3111
310 Whitehead Ave. W.
New Liskeard, ON P0J 1P0
Canada
www.exp.com

05/2024 10:48:42 AM S:\ENGINEERING\PROJECTS\FEDERATION\MOOSONEE DOG HOLDING FACILITY\PROJECT EXECUTION\DWG\MOOSONEE DOG HOLDING FACILITY.DWG

TYPICAL SECTION

ORIENTATION

PLAN ONLY (APPROXIMATE)

CAUTION: DO NOT SCALE DRAWINGS.
THIS REPRODUCTION MAY BE AT A SIZE DIFFERENT THAN ORIGINALLY DRAWN. EXP ASSUMES NO RESPONSIBILITY FOR INCORRECT SCALING, UNAUTHORIZED REPRODUCTION OR REUSE IS STRICTLY PROHIBITED, NOT PUBLISHED - ALL RIGHTS RESERVED. EXP EXPRESSLY DISCLAIMS RESPONSIBILITY ARISING FROM UNAUTHORIZED USE OF THESE DRAWINGS AND NOTES. AUTHORIZATION MUST BE IN WRITING.

© exp, 2024

DIMENSIONS NOTES
1. ALL DIMENSIONS ARE IN METERS (m) UNLESS NOTED OTHERWISE.

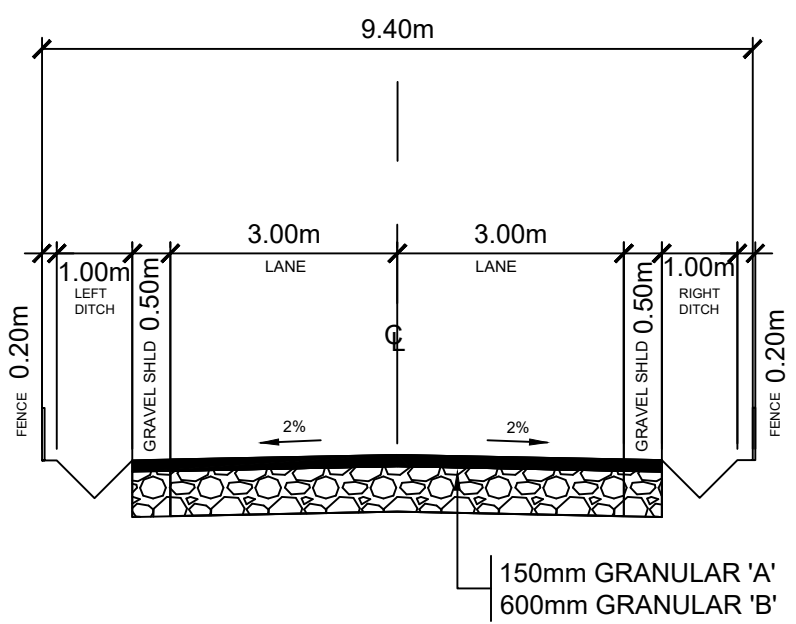

TYPICAL SECTION 1
20+080 TO 20+125

SCALE: 1:100

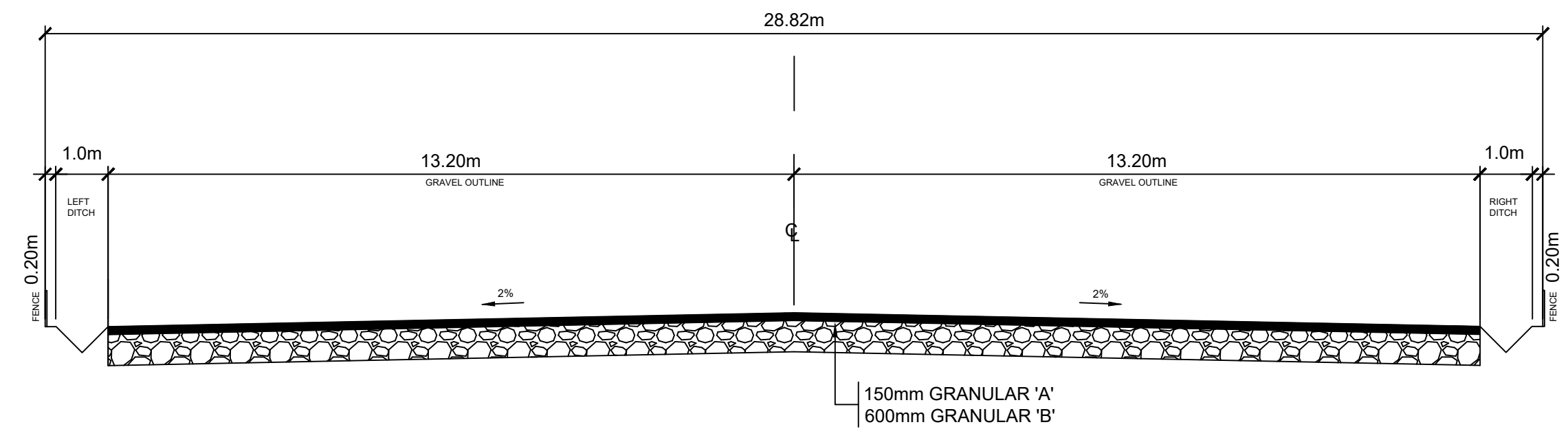

TYPICAL SECTION 1
20+000 TO 20+040

SCALE: 1:100

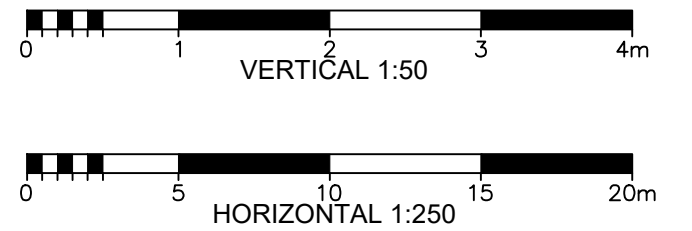

No.	DATE (YYMMDD)	REVISION	BY
-----	---------------	----------	----

CLIENT
TOWN OF MOOSONEE

PROJECT TITLE
MOOSONEE DOG HOLDING FACILITY

PROJECT No. **NWL - 24010098**

DRAWING TITLE
NEW CONSTRUCTION / GRADING PLAN

DRAFT	DESIGNED	SCALE
	????	1:500
	DRAWN	PLAN No.
AG	???	
CHECKED	DRAWING No.	
???		

EXP Services Inc.
1-705-647-4311 | F. 1-705-647-3111
310 Whitewood Ave. W.
New Liskeard, ON P0J 1P0
Canada
www.exp.com

18/03/24 10:00:02 AM S:\ENGINEERING\PROJECT FILES\2024\NWL-24010098\MOOSONEE DOG HOLDING FACILITY\PROJECT EXECUTION\EXP DRAWINGS\DWG.DWG

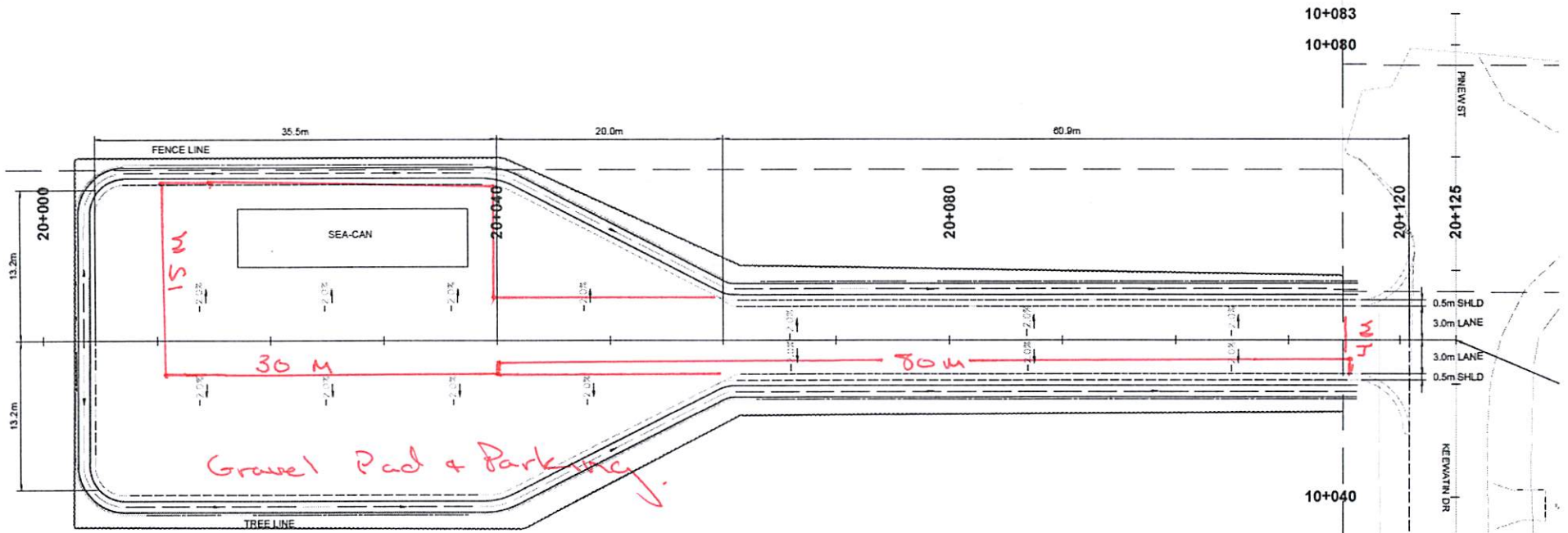

Driveway = $80 \text{ m} \times 4 \text{ m} \times 0.2032 \text{ m (8 inches)}$
 $\approx 65 \text{ m}^3$
 Pad + ~~Driveway~~ Parking = $30 \text{ m} \times 15 \text{ m} \times 0.2032 \text{ m (8 inches)}$
 $\approx 92 \text{ m}^3$

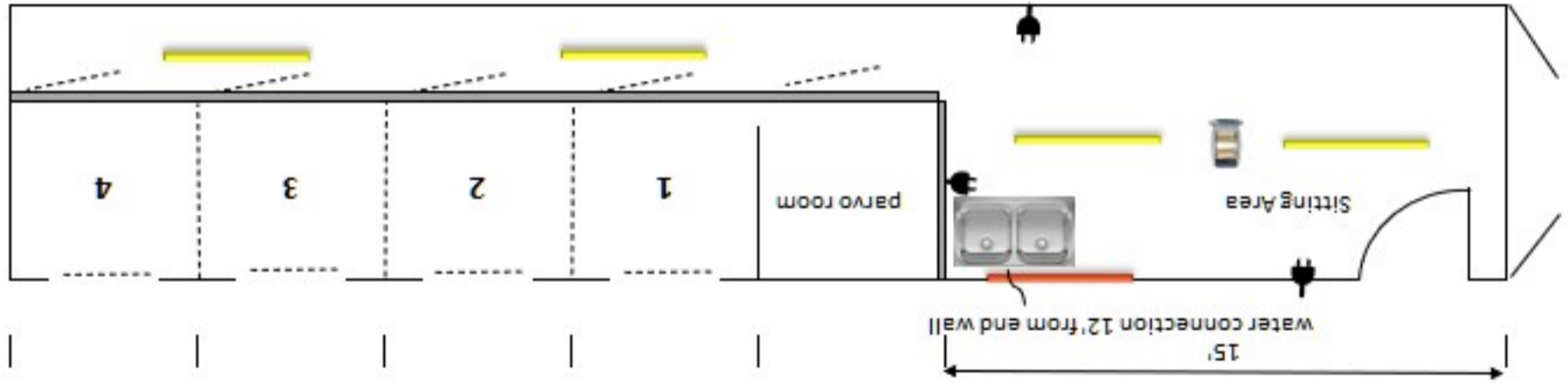

Moosonee Pu
Works Dep

Dog Holding Facility

